

Plasma Booster Installation Instructions for MINI







Thank you for purchasing the Plasma Booster. We appreciate your confidence in our product. Please read this instruction carefully to make a proper and safe installation.

Safety Instructions: Caution

1. Installation should be made only on the designated car and model.
2. Never modify or dismantle this product.
3. The vehicle should be on a flat surface, with tires blocked to prevent the car from rolling.
4. The engine should be off and completely cooled. Be sure the ignition key is not inserted.
5. The negative terminal from the battery should be disconnected. However, this may cause the security alarm to activate. Please consult the vehicle owner's manual to prevent this from occurring.
6. The engine should be in good operating condition. Any sign of defects should be corrected (repaired) before installation.
7. Make sure the air circulation is good before running the engine.
8. Never mount the Plasma Booster on surfaces that get very hot.
9. Never connect Plasma Booster wires to the part that get very hot, such as muffler, fuel hose or brake hose.
10. Installation should be performed by a professional mechanic.
11. If the engine performance previously boosted through modification of the ignition timing or air/fuel ratio, it may require readjustment following installation of the Plasma Booster.
12. If any defects are found in the Plasma Booster, discontinue using it immediately and contact the dealer where you purchased the product, or Okada Projects.

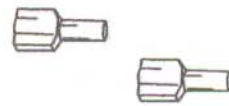
Parts Included

Plasma Booster x1 	Quick Connector A x2 	Quick Connector B x2 	Ground Lug (6mm) x1 Ground Lug (8mm) x1 	Double-Sided foam Tape x1 
---	---	---	---	--

Installation Diagram

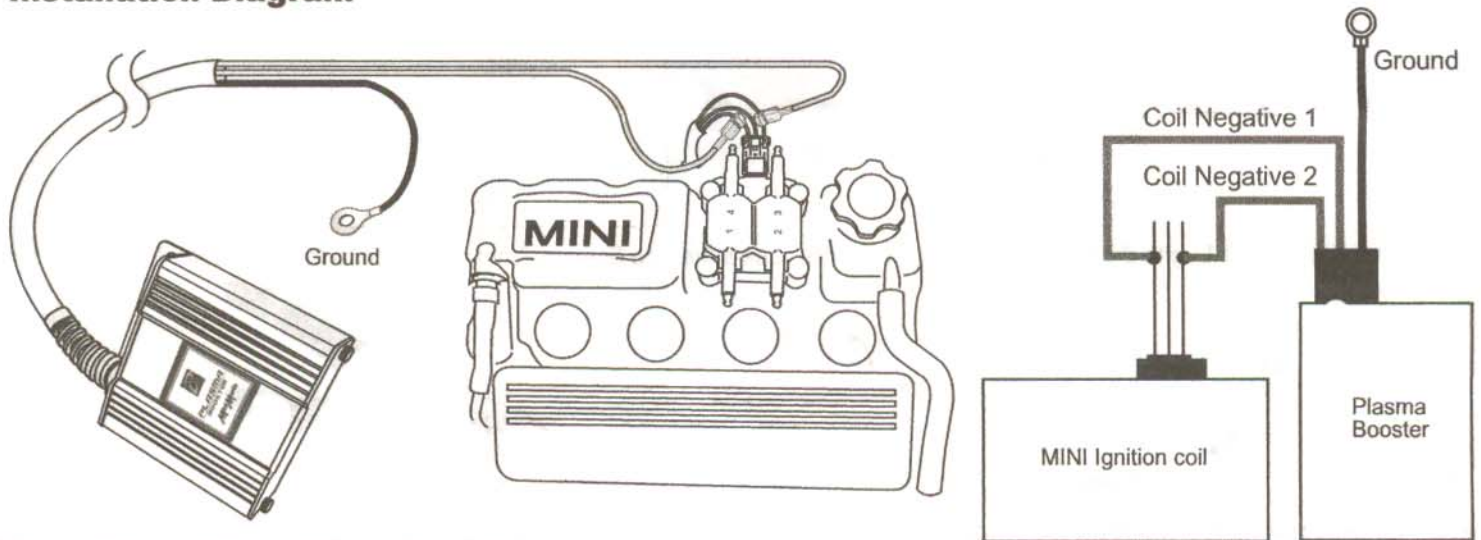

Mount the Plasma Booster with the double-sided foam tape. Connect the colored wires to the negative wires of the coil using the quick connector A and B. Ground the black wire to the negative battery terminal, the engine block or the car body.

Installation Procedure

- 1 Please disconnect negative(-) battery terminal at the beginning of the installation. Note: it takes approx. 20 minutes to reset the ECU.
- 2 Disconnect the ignition coil connector from the coil.
- 3 Place the Plasma Booster on top of the fuse box. Clean the fuse box cover before attaching the Plasma Booster. Attach the double-sided foam tape provided to the bottom center of the unit. Align boxes as shown. Press down to make sure the Plasma Booster is securely in place.
You can also choose any other suitable location to install the Plasma Booster with either the double sided tape.
The wiring harness can be run behind the stock air box to conceal it. Use tie wraps or wire covers to hold it in place.
Run the wiring harness to the coil pack as shown. We recommend that the car has cooled down before starting this job. Use the supplied wiring clips to attach to the three wires.

- 4 Connect one quick connector A to the blue/black wire, and the other to the yellow/black or red/black wire. (If the wires cannot be identified clearly, please contact the dealer or Okada Projects.)

But the Splice Quick-Slide Connector is not recommend for the Mini cooper. We strongly recomend wire to be connected by soldering.

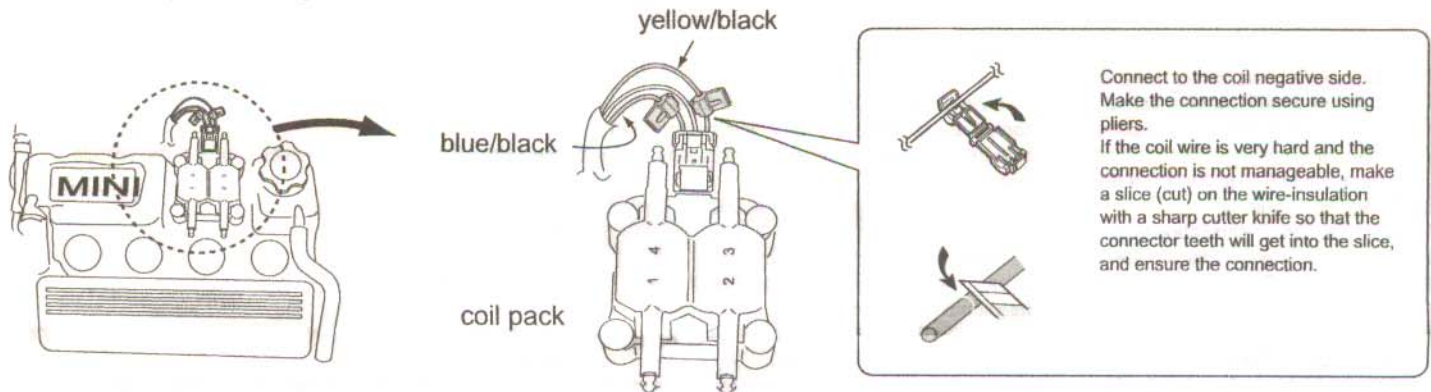

- 5 Connect the Quick Connector Bs to the Plasma Booster blue colored-wires using the Crimp tool.

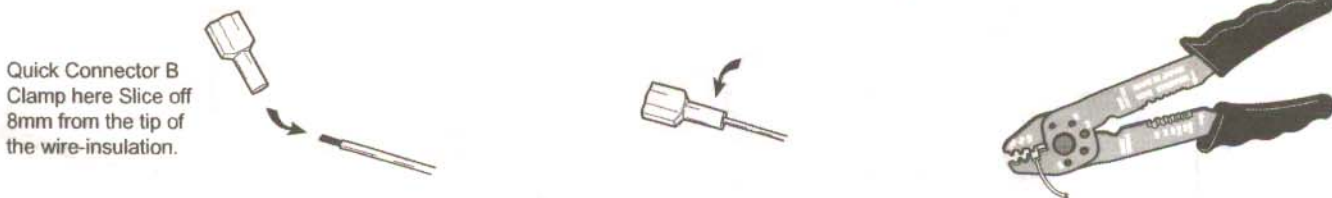

- 6 Connect one Quick Connector B of the Plasma Booster colored wire to a Quick connector A of the blue/black wire, and the other to the Quick Connector A of the yellow/black wire.



- 7 Connect the Ground Lug to the Plasma Booster black wire. Use either the 6mm or 8mm, according to the hole size of the grounded object.

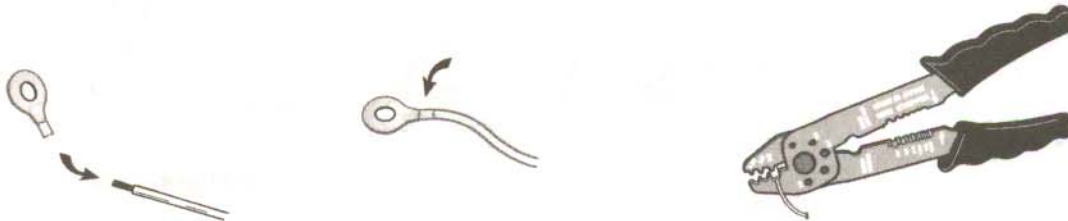

- 8 Ground the Plasma Booster black wire mentioned in Step 7 above the negative battery terminal, the engine block, or to the car body.



Attach the Black Plasma Booster wire to the bracket assembly as shown (GROUND). The wire connector should sit on the aluminum bracket and then be bolted together.

- 9 Run the engine and check the LED lights on the Plasma Booster. The lights should be ON if the installation has been properly done and the part is in working condition.